

Grab Hooks with supporting lugs

Loadmax Lever style Load Binder with winged Grab Hooks combined with Grade 70 Chain are an effective way to restraint heavy loads for transport operations. Commonly used to tie down Steel, Plant Equipment, Timber and other general cargo applications.

- Load Binder to suit Chain sizes from 6mm to 13mm available.
- Manufactured from dropped forged steel quenched and tempered.
- Marked with Chain size, lashing capacity, grade, batch numbered and branded Loadmax for traceability
- All Load Binders come with swivel winged Grab Hooks to achieve full lashing capacity
- Batch Test Certificate available upon request.
- Comply with AS 4344.

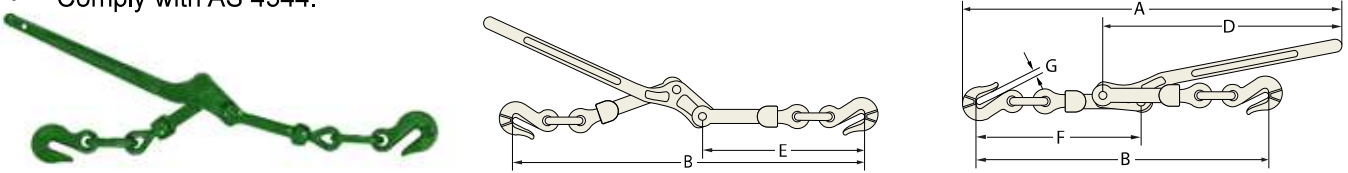

CODE	CHAIN SIZE	LASHING CAPACITY		MBF	Wt.	DIMENSIONS						
		G70 Chain	G80 Chain			KN	kg	A mm	B mm	C mm	D mm	E mm
202006	6	2300kg	2300kg	44	2.4	540	475	390	390	225	220	8.9
202008	7 - 8	3800kg	4100kg	84	3.2	610	560	455	405	265	264	12.7
202010	10	6000kg	6400kg	125	5.6	730	655	540	420	313	315	16
202013	13	9000kg	10500kg	205	8.9	790	830	635	535	370	350	18

Safety Lever Style (BX600)

Grab Hooks with supporting lugs

Loadmax Safety Lever style Load Binder with winged Grab Hooks combined with Grade 70 Chain are an effective way to restraint heavy loads for transport operations with the added safety feature of a recoilless handle.

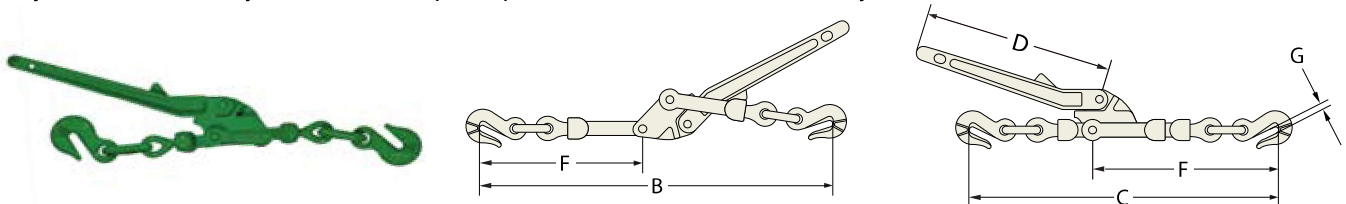

CODE	CHAIN SIZE	LASHING CAPACITY		MBF	Wt.	DIMENSIONS				
		G70 Chain	G80 Chain			KN	kg	C mm	D mm	E mm
202615	8	3,800kg	4,100kg	85	4.2	600	320	280	280	940
202620	10	6,000kg	6,400kg	130	6.5	720	380	320	320	1020

Standard Lever Style

Claw Hooks

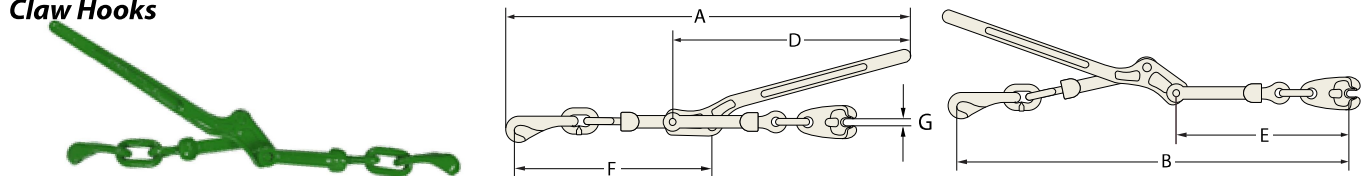

CODE	CHAIN SIZE	LASHING CAPACITY		MBF	Wt.	DIMENSIONS						
		G70 Chain	G80 Chain			KN	kg	A mm	B mm	C mm	D mm	E mm
202108	8	3800kg	4100kg	84	3.9	635	640	545	395	310	310	11.9
202110	10	6000kg	6400kg	125	5.6	715	729	625	445	345	345	14.9